

The #9800 Cabinet Hardware Mounting Jig is an easy to use and versatile tool for consistent, repeatable and accurate placement of cabinet doorknobs and drawer pulls.

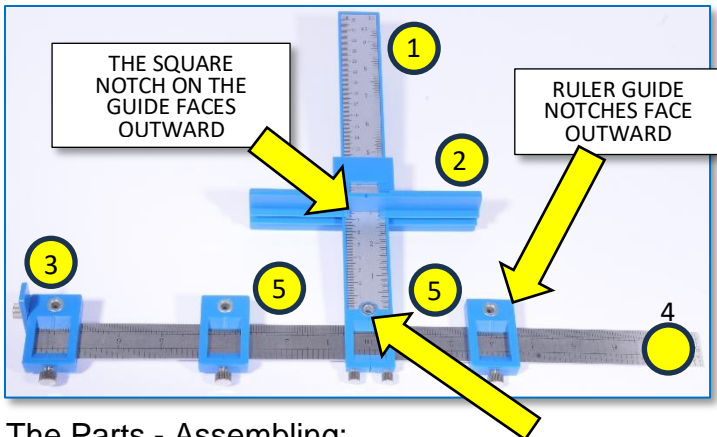

The Parts - Assembling:

- (1) Height/Depth Setting Ruler.
- (2) Height/Depth Guide.
- (3) Sliding Edge Guide.
- (4) Width/Height Setting Ruler.
- (5) Hardware Setting Guides.

For Drawer Hardware -

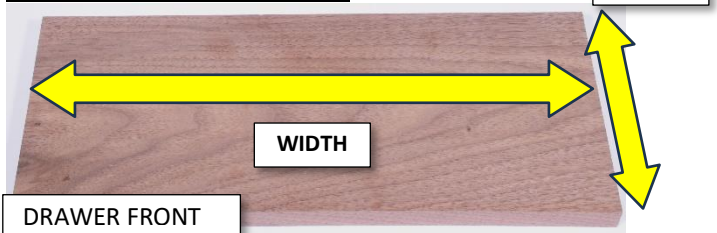

- Measure the drawer front width.
- Divide that measurement in half.
- Mark the top rear side of the drawer at that measurement.
- Align the notch on the **back** of the Height/Depth Guide to that mark.
- Adjust the Height/Depth Guide to the desired offset from the top of the drawer.
- Adjust the drilling guides to your hardware!

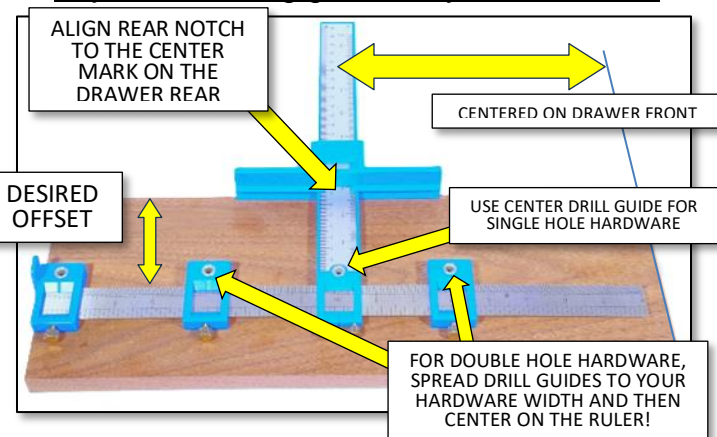

For Door Hardware, there are four different applications, upper left/right, lower left/right.

- Set the Edge Guide to the end of Width/Height Setting Ruler. This provides a repeatable edge reference.
- Measure the width of your Stiles (verticals).
- Divide that measurement in half.
- Adjust the Height/Depth Guide to that measurement. This will center on the Stile.
- Measure the height of your Rails (horizontal).
- Divide that measurement in half.
- Align the Hardware Setting Guide to that measurement. This is an ideal spot for single hole hardware.
- For two-hole hardware, slide the Height Depth Guide to the width of your hardware.
- Always use both Hardware Setting Guides to keep your jig square/level to the door!
- Mark with a pencil before you drill!
- Once you have your settings dialed in, flip the jig over to switch door positions.

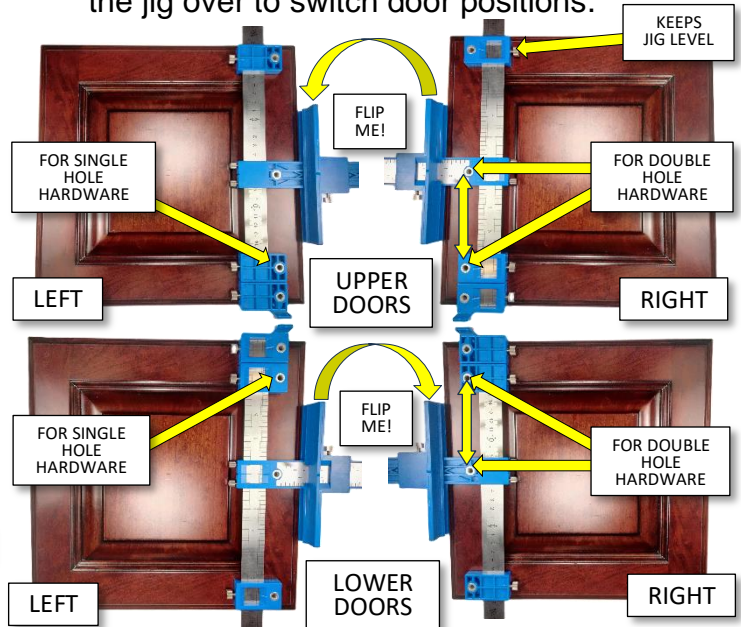

While hardware placement has general rules, your own esthetic decisions will decide the final placement.

NOTE: a 3/16" Brad Point drill bit is ideal for drilling your holes!